

REAR DOCK AREA SUMMARY - CFP-7		
OCCUPANCY USE	ROOM NAME	SQUARE FOOTAGE
MERCANTILE (M)	SALES / VESTIBULE	15,523
	MEN'S ROOM	107
	WOMEN'S ROOM	105
	HALL	293
SUBTOTAL (MERCANTILE)		16,028
BUSINESS (B)	OFFICE	403
	BREAK ROOM	407
SUBTOTAL (BUSINESS)		810
STORAGE / STOCK (S-1)	BACKROOM	4,697
	COOLER	1,313
	FREEZER	726
SUBTOTAL (STORAGE / STOCK)		6,736
SUBTOTAL (OCCUPANCIES)		23,574
EXTERIOR / INTERIOR WALLS / UNOCCUPIED SPACE		1,207
BUILDING SQUARE FOOTAGE		24,781
EXTERIOR CANOPY		1,039
TOTAL SQUARE FOOTAGE (INCLUDING CANOPY)		25,820

REAR DOCK OPERATIONS DATA - CFP-7		
ITEM	V8.0 PROTOTYPE	SIBLEY PLAZA, ST. PAUL, MN
LINEAR FOOTAGE OF BASE (PRODUCE INCLUDED)	906'-2"	910'-0"
ASSUMED PALLET STORAGE	76	93
BUILDING DIMENSIONS	119'-4" x 178'-0"	145'-0" x 178'-0"
SALES FLOOR DIMENSIONS	74'-5" x 175'-9"	95'-3 1/4" x 164'-5 1/2"
LENGTH OF MULTIDECK	116'	132'
COOLER MILK DOORS	4	4
COOLER GENERAL DOORS	12	12
FREEZER GENERAL DOORS	16	18
SPOT MERCHANDISERS	13	12
CART STORAGE	[144] MODEL 563W	[144] MODEL 563W

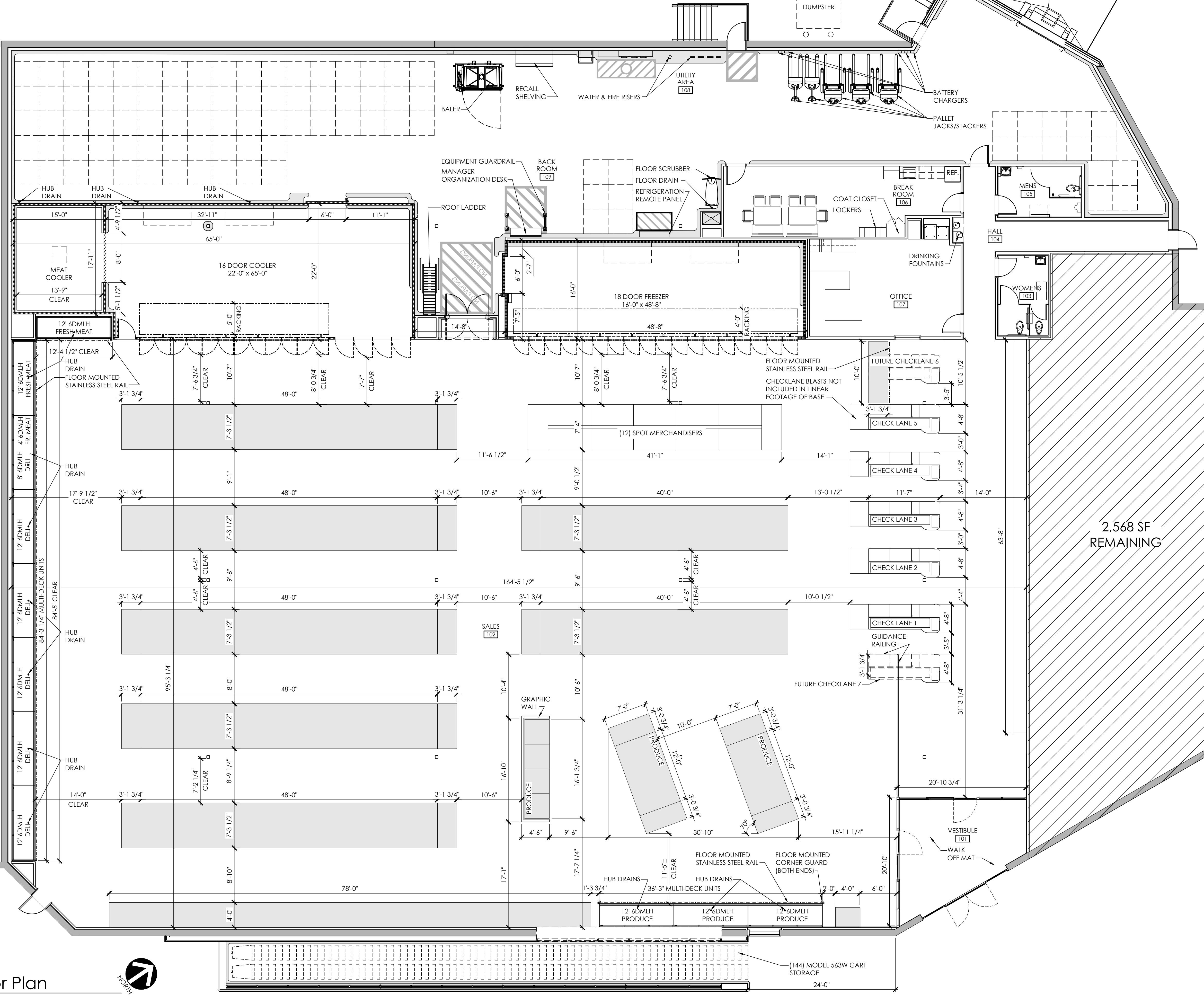

ADJACENT TENANT (N.I.C.)

- NOTES:
- THIS DRAWING IS FOR GENERAL FIXTURING LAYOUT AND REFERENCE TO EQUIPMENT ONLY. ALL INFORMATION IS FOR ALDI OPERATIONAL USE ONLY AND SHALL NOT BE USED FOR CONSTRUCTION OR BIDDING PURPOSES.
 - ALL DIMENSIONS TO WALLS ARE TO FACE OF STUD.
 - ALL SHELVING DIMENSIONS ARE TO FACE OF GONDOLA.
 - THIS FACILITY DOES NOT CONTAIN A BAKERY, A BUTCHER, A DELI OR FISH COUNTER.
 - ALL FOOD IS PREPACKAGED. THERE IS NO ON SITE FOOD PREPARATION.
 - GONDOLA LOCATIONS ARE MEASURED FROM THE FACE OF THE STAINLESS STEEL PRICE TAG MOLDING (SPTM).

1 Concept Floor Plan
SCALE: 1/8" = 1'-0"

PLOTTED: 6/12/2018 11:28 AM

Issued:	Date:
A Issued for Client Review	05/04/18
B Issued for Client Review	05/25/18
C Issued for Client Review	06/01/18
D	06/12/18
E	

Revisions:	Date:
1	
2	
3	
4	
5	
6	
7	
8	
9	

Copyright © 2018
APD Engineering & Architecture, PLLC
Drawing Alteration
It is a violation of law for any person, unless acting under the direction of licensed Architect, Professional Engineer, Landscape Architect, or Land Surveyor to alter any item on this document in any way. Any licensee who alters this document is required by law to affix his or her seal and to add the notation "Altered By" followed by his or her signature and the specific description of the alteration or revision.

DO NOT SCALE PLANS
Copying, Printing, Software and other processes required to produce these prints can stretch or shrink the actual paper or layout. Therefore, scaling of this drawing may be inaccurate. Contact APD &EA with any need for additional dimensions or clarifications.

APD ENGINEERING & ARCHITECTURE, PLLC
615 Fishers Run
Victor, NY 14564
585.742.2222
585.924.4914 fax
www.apd.com

ALDI Inc.
4201 Bagley Avenue North
Faribault, MN 55021
(507) 333-8465
(507) 333-9475 fax

ALDI Inc. Store #: XX
St. Paul - Sibley Plaza
2481 7th St. W
St. Paul, MN 55116
Ramsey County
Project Name & Location:

Concept Floor Plan Drawing Name:		Project No. 17-0446A
Date:	05/04/18	
Type:	Retrofit	
Drawn By:	KY	CFP-7
Scale:	As Noted	Drawing No.